



ALISRA OTOMOTİV TALAŞLI İMALAT İTH. İHR. SAN. VE TİC. LTD. ŞTİ.



   ALISRA OTOMOTİV TALAŞLI İMALAT
info@alisra.com.tr - info@alisraotomotiv.com

 Fevzi Çakmak Mah. Kobisan 3 San. Sit.

Sıla Cad. No:73/AC **Karatay/KONYA/TÜRKİYE**

 +90 332 248 15 10

 +90 332 248 46 17

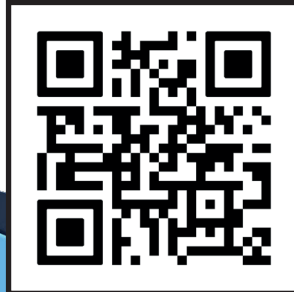



HIZLI VE KALİTELİ ÜRETİMDE GÜVENİLİR ÇÖZÜM
RELIABLE SOLUTION FOR FAST AND HIGH QUALITY PRODUCTION

ÜRÜN KATALOĞU
PRODUCT CATALOG

KISA TANITIM

SHORT INTRODUCTION

Alisra Otomotiv Talaşlı İmalat İth. İhr. San. Ve Tic. Ltd. Şti. 1989 yılında 50 metrekare alan ve 1 mekanik torna tezgahı ile üretime başlayarak o yılların zor şartlarında üretimde süreklilik ve kaliteden ödün vermeden hedeflenen yolda emin adımlarla yürümeyi ilke edindi.

Son gelinen noktada 1000 metrekare alanda çeşitli CNC Torna Tezgahları, Otomatik ve Mekanik Torna Tezgahları, Kollu Robot ve üretim için gerekli tüm ekipmanlarla birlikte alanında uzman personellerle çeşitli alanlarda istihdam ve kariyer gelişimlerine imkan sağlayarak faaliyetlerine devam etmektedir.

Alisra Automotive Machining Import. Export. Industry and Trade Co. Ltd. Co. started production in 1989 in a 50 square meter area and a mechanical lathe, adopting the principle of taking the desired path with sure steps without compromising on the continuity and quality of production under the difficult conditions of those years.

To date, the company continues its activities by providing employment and career development opportunities in various fields with professional personnel in a 1000 square meter area with various CNC lathes, automatic and mechanical lathes, arm robots and all equipment necessary for production.

MİSYON

MISSION

Çevreye ve insana duyarlı bir işletme modeli olarak, kaliteli - cazip ürün elde edilip süreklilik sağlanarak, geniş ve çeşitli makine kapasitesiyle sanayinin her dalında üretim yapmakta, yurt içi ve yurt dışındaki müşterilere istenilen üründe tedarik imkanı sağlanmaktadır.

As a business model that is sensitive to the environment and people, we produce quality and attractive products and ensures continuity, and produces in every branch of the industry with its wide and diverse machine capacity, and provides the opportunity to supply the desired product to domestic and foreign customers.

VİZYON

VISION

Endüstri 4.0 konseptini benimseyerek; verimlilik, otomasyon, nesnelerin interneti, artırılmış gerçeklik, katmanlı üretim, kalite ve dijitalizasyonu yükseltmek için, endüstriyel üretimi Ar-Ge çalışmalarıyla profesyonelleştirmektedir.

By adopting the Industry 4.0 concept; to professionalize industrial production with R&D studies in order to increase efficiency, automation, internet of things, augmented reality, layered production, quality and digitalization.



ÜRÜN GRUPLARI

PRODUCT GROUPS

ÜRÜNLER

- Tarım ilaçlama makineleri yedek parçası
- Otomotiv fren kaliperleri yedek parçası
- Talaşlı imalatta fason yedek parça
- CNC otomat revolver fason parçası
- Yağmurlama ek metal yedek parçası
- Siparişe özel yedek parça

CNC TURNING SERVICES FOR BRANCHES

- Agricultural and Construction Machinery
- Automotive Industry
- Crane and Lifting Technology
- Mechanical and Plant Engineering
- Logistics and Warehouse Technology
- And many more

MALZEMELER

- Çelik
- Krom
- Sarı
- Alüminyum
- Derin

MATERIALS

- Carbon Steels
- Tempered Steels
- Case-hardening Steels
- Rust and Acid Resistant Steels
- Free Cutting Steels
- Aluminium
- Bronze
- Brass
- PVC, PE, PP, POM
- PA, PTFE



REKOR FITTING

PN(BAR) BASINÇ	TUBE Ø BORU ÇAP(d)	G	M	ITEM CODE PARÇA KODU
L NORMAL BASINÇ / L NORMAL PRESSURE	6L	R1/8-28	M12X1.5	ALS-0001
	8L	R1/8-28	M14X1.5	ALS-0002
	10L	R1/8-28	M16X1.5	ALS-0003
	6L	R1/4-19	M12X1.5	ALS-0004
	8L	R1/4-19	M14X1.5	ALS-0005
	10L	R1/4-19	M16X1.5	ALS-0006
	12L	R1/4-19	M18X1.5	ALS-0007
	6L	R3/8-19	M12X1.5	ALS-0008
	8L	R3/8-19	M14X1.5	ALS-0009
	10L	R3/8-19	M16X1.5	ALS-0010
	12L	R3/8-19	M18X1.5	ALS-0011
	6L	R1/2-14	M12X1.5	ALS-0012
	8L	R1/2-14	M14X1.5	ALS-0013
	10L	R1/2-14	M16X1.5	ALS-0014
	12L	R1/2-14	M18X1.5	ALS-0015
	15L	R1/2-14	M22X1.5	ALS-0016
	18L	R1/2-14	M26X1.5	ALS-0017
	22L	R1/2-14	M30X2	ALS-0018
	12L	R3/4-14	M18X1.5	ALS-0019
	15L	R3/4-14	M22X1.5	ALS-0020
	18L	R3/4-14	M26X1.5	ALS-0021
	22L	R3/4-14	M30X2	ALS-0022
	28L	R3/4-14	M36X2	ALS-0023
	22L	R1-11	M30X2	ALS-0024
	28L	R1-11	M36X2	ALS-0025
	35L	R1-1/4-11	M45X2	ALS-0026
	42L	R1-1/4-11	M52X2	ALS-0027
	35L	R1-1/2-11	M45X2	ALS-0028
	42L	R1-1/2-11	M52X2	ALS-0029

PN(BAR) BASINÇ	TUBE Ø BORU ÇAP(d)	G	M	ITEM CODE PARÇA KODU
S YÜKSEK BASINÇ / S HIGH PRESSURE	8S	R1/8-28	M16X1,5	ALS-0030
	8S	R1/4-19	M16X1,5	ALS-0031
	10S	R1/4-19	M18X1.5	ALS-0032
	12S	R1/4-19	M20X1.5	ALS-0033
	10S	R3/8-19	M18X1.5	ALS-0034
	12S	R3/8-19	M20X1.5	ALS-0035
	16S	R3/8-19	M24X1.5	ALS-0036
	10S	R1/2-14	M18X1.5	ALS-0037
	12S	R1/2-14	M20X1.5	ALS-0038
	16S	R1/2-14	M24X1.5	ALS-0039
	20S	R1/2-14	M30X2	ALS-0040
	25S	R1/2-14	M36X2	ALS-0041
	12S	R3/4-14	M20X1.5	ALS-0042
	16S	R3/4-14	M24X1.5	ALS-0043
	20S	R3/4-14	M30X2	ALS-0044
	25S	R3/4-14	M36X2	ALS-0045
	30S	R3/4-14	M42X2	ALS-0046
	16S	R1-11	M24X1.5	ALS-0047
	20S	R1-11	M30X2	ALS-0048
	25S	R1-11	M36X2	ALS-0049
	30S	R1-11	M42X2	ALS-0050
	20S	R1-1/4-11	M30X2	ALS-0051
	25S	R1-1/4-11	M36X2	ALS-0052
	30S	R1-1/4-11	M42X2	ALS-0053
	38S	R1-1/4-11	M52X2	ALS-0054
	25S	R1-1/2-11	M36X2	ALS-0055
	30S	R1-1/2-11	M42X2	ALS-0056
	38S	R1-1/2-11	M52X2	ALS-0057

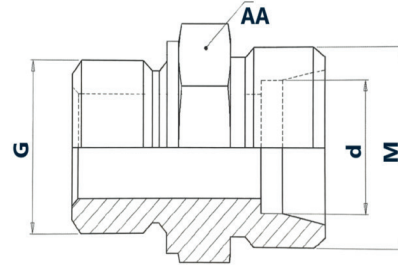
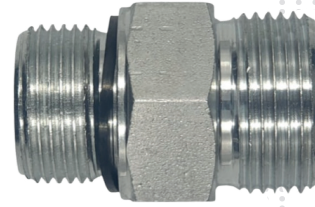

UNF KAYNAKLIK NİPEL

UNF WELDING NIPPLE



BSP KAYNAKLIK NİPEL

BSP WELDING NIPPLE

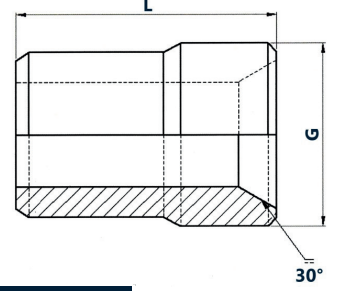

UNF	ITEM CODE PARÇA KODU
W1/2-20	ALS-0295
W9/16-18	ALS-0296
W5/8-18	ALS-0297
W3/4-16	ALS-0298
W7/8-14	ALS-0299
W1-1/16-12	ALS-0300
W1-5/16-12	ALS-0301

G	ITEM CODE PARÇA KODU
R1/8-19	ALS-0286
R1/4-19	ALS-0287
R3/8-19	ALS-0288
R1/2-14	ALS-0289
R3/4-14	ALS-0290
R1-11	ALS-0291
R1-1/4-11	ALS-0292
R1-1/2-11	ALS-0293
R2-11	ALS-0294

METRİK YUVARLAK KAYNAKLIK NİPEL

METRIC MALE THREAD WELDING NIPPLE

TUBE Ø BORU ÇAPID)	M	ITEM CODE PARÇA KODU
8L	M14X1.5	ALS-0302
10L	M16X1.5	ALS-0303
12L	M18X1.5	ALS-0304
12S	M20X1.5	ALS-0305
15L	M22X1.5	ALS-0306
16S	M24X1.5	ALS-0307
20S	M30X2	ALS-0308
22L	M30X2	ALS-0309
25S	M36X2	ALS-0310
28L	M36X2	ALS-0311
30S	M42X2	ALS-0312
38S	M52X2	ALS-0313
42L	M52X2	ALS-0314

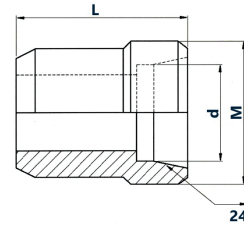

METRİK ALTI KÖŞE KAYNAKLIK NİPEL

METRIC HEX CORNER WELDING NIPPLE

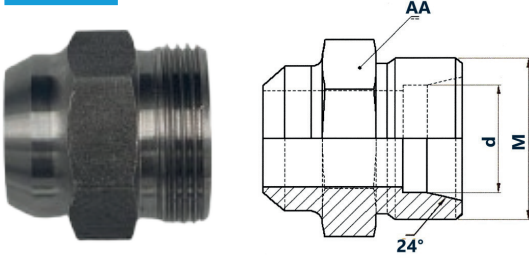

TUBE Ø BORU ÇAPİ(d)	M	ITEM CODE PARÇA KODU
8L	M14X1.5	ALS-0315
10L	M16X1.5	ALS-0316
12L	M18X1.5	ALS-0317
12S	M20X1.5	ALS-0318
15L	M22X1.5	ALS-0319
16S	M24X1.5	ALS-0320
20S	M30X2	ALS-0321
22L	M30X2	ALS-0322
25S	M36X2	ALS-0323
28L	M36X2	ALS-0324
30S	M42X2	ALS-0325
38S	M52X2	ALS-0326
42L	M52X2	ALS-0327

KAYNAKLIK MANŞON

FEMALE THREAD COUPLING FOR WELD

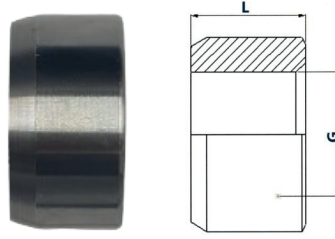

G	L	ITEM CODE PARÇA KODU
R1/8-28	14	ALS-0328
R1/4-19	15	ALS-0329
R3/8-19	15	ALS-0330
R1/2-14	18	ALS-0331
R3/4-14	20	ALS-0332
R1-11	23	ALS-0333
R1-1/4-11	25	ALS-0334
R1-1/2-11	27	ALS-0335
R2-11	30	ALS-0336

MANŞON

COUPLING

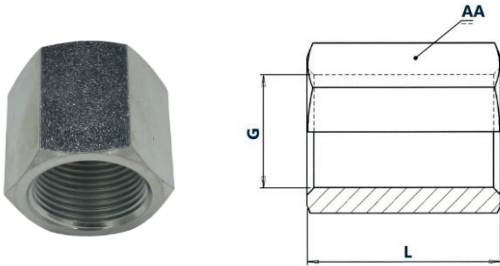

G	L	AA	ITEM CODE PARÇA KODU
R1/8-28	14	14	ALS-0337
R1/4-19	15	19	ALS-0338
R3/8-19	15	22	ALS-0339
R1/2-14	18	27	ALS-0340
R3/4-14	20	32	ALS-0341
R1-11	23	41	ALS-0342
R1-1/4-11	25	50	ALS-0343
R1-1/2-11	27	55	ALS-0344
R2-11	30	70	ALS-0345

BSP NİPEL

BSP NIPPLE

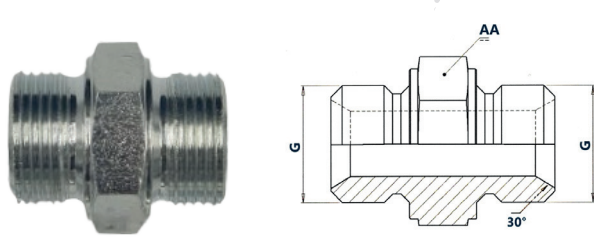

G	AA	ITEM CODE PARÇA KODU
R1/8-28	14	ALS-0346
R1/4-19	19	ALS-0347
R3/8-19	22	ALS-0348
R1/2-14	27	ALS-0349
R3/4-14	32	ALS-0350
R1-11	41	ALS-0351
R1-1/4-11	50	ALS-0352
R1-1/2-11	55	ALS-0353
R2-11	70	ALS-0354
R2-1/2-11		ALS-0355
R3		ALS-0356

BSP ORANTILI NİPEL

BSP STRAIGHT REDUCER

G	G1	AA	ITEM CODE PARÇA KODU
R1/8-28	R1/4-19	14	ALS-0357
R1/8-28	R3/8-19	22	ALS-0358
R1/4-19	R3/8-19	22	ALS-0359
R1/4-19	R1/2-14	27	ALS-0360
R1/4-19	R3/4-14	32	ALS-0361
R3/8-19	R1/2-14	27	ALS-0362
R3/8-19	R3/4-14	32	ALS-0363
R1/2-14	R3/4-14	32	ALS-0364
R1/2-14	R1	41	ALS-0365
R3/4-14	R1-11	41	ALS-0366
R3/4-14	R1-1/4-11	50	ALS-0367
R3/4-14	R1-1/2-11	55	ALS-0368
R1-11	R1-1/4-11	50	ALS-0369
R1-11	R1-1/2-11	55	ALS-0370
R1-1/4-11	R1-1/2-11	55	ALS-0371
R1-1/4-11	R2	70	ALS-0372
R1-1/2-11	R2	70	ALS-0373
R2-11	R2-1/2-11		ALS-0374

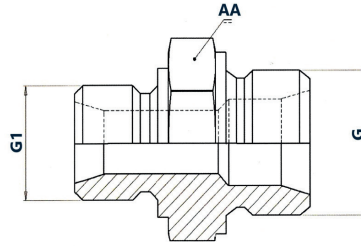

METRİK NİPEL

METRIC NIPPLE

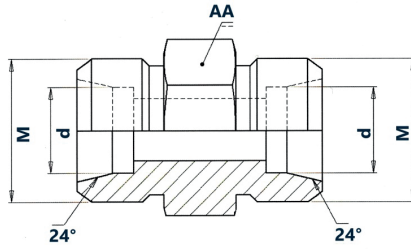
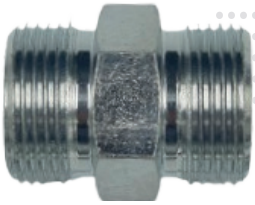

PN(BAR) BASINÇ	TUBE Ø BORU ÇAPI(d)	M	AA	ITEM CODE PARÇA KODU
L NORMAL BASINÇ L NORMAL PRESSURE	6L	M12X1.5	14	ALS-0375
	8L	M14X1.5	17	ALS-0376
	10L	M16X1.5	17	ALS-0377
	12L	M18X1.5	19	ALS-0378
	15L	M22X1.5	24	ALS-0379
	18L	M26X1.5	27	ALS-0380
	22L	M30X2	32	ALS-0381
	28L	M36X2	41	ALS-0382
	35L	M45X2	46	ALS-0383
	42L	M52X2	55	ALS-0384

PN(BAR) BASINÇ	TUBE Ø BORU ÇAPI(d)	M	AA	ITEM CODE PARÇA KODU
S YÜKSEK BASINÇ S HIGH PRESSURE	8S	M16X1.5	M16X1.5	ALS-0385
	10S	M18X1.5	M18X1.5	ALS-0386
	12S	M20X1.5	M20X1.5	ALS-0387
	16S	M24X1.5	M24X1.5	ALS-0388
	20S	M30X2	M30X2	ALS-0389
	25S	M36X2	M36X2	ALS-0390
	30S	M42X2	M42X2	ALS-0391
	38S	M52X38	M52X38	ALS-0392

REDÜKSİYON NİPEL

REDUCER NIPPLE

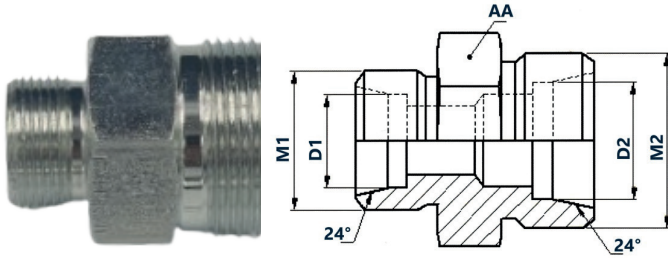

M1	D1	M2	D2	AA	ITEM CODE PARÇA KODU
M12X1.5	6	M14X1.5	8	17	ALS-0393
M12X1.5	6	M16X1.5	10	17	ALS-0394
M14X1.5	8	M16X1.5	10	17	ALS-0395
M16X1.5	10	M18X1.5	12	19	ALS-0396
M18X1.5	12	M24X1.5	16	27	ALS-0397
M20X1.5	12	M24X1.5	16	27	ALS-0398
M18X1.5	12	M30X2	20	32	ALS-0399
M20X1.5	12	M30X2	20	32	ALS-0400
M24X15	16	M30X2	20	32	ALS-0401
M24X15	16	M36X2	25	41	ALS-0402
M30X2	20	M36X2	25	41	ALS-0403
M30X2	20	M42X2	30	46	ALS-0404
M36X2	25	M42X2	30	46	ALS-0405
M30X2	20	M52X2	38	55	ALS-0406
M36X2	25	M52X2	38	55	ALS-0407
M42X2	30	M52X2	38	55	ALS-0408

UNF NİPEL

UNF NIPPLE

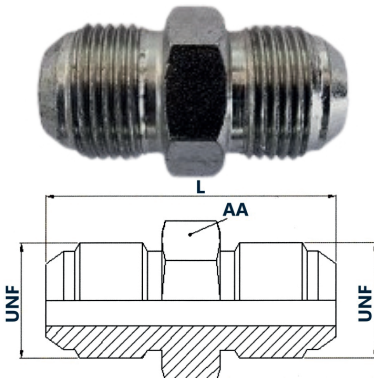

UNF	AA	ITEM CODE PARÇA KODU
7/16-20	12	ALS-0409
1/2-20	14	ALS-0410
9/16-18	17	ALS-0411
5/8-18	17	ALS-0412
3/4-16	22	ALS-0413
7/8-14	24	ALS-0414
1-1/16	30	ALS-0415
1-5/16	36	ALS-0416
1-5/8	46	ALS-0417
1-7/8	50	ALS-0418

BSP UNF REKOR

BSP UNF FITTING

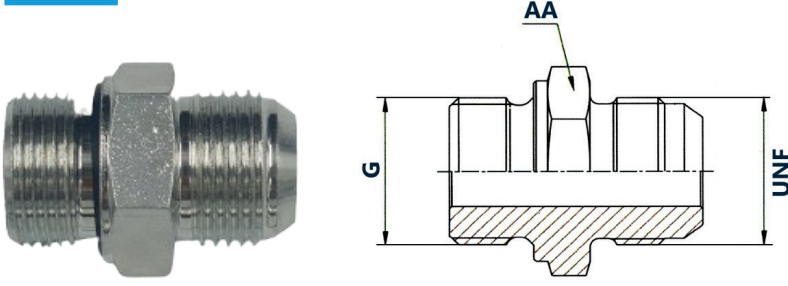

UNF	G	AA	ITEM CODE PARÇA KODU
R1/8-28	7/16-20	14	ALS-0419
R1/4-19	9/16-18	19	ALS-0420
R1/4-19	7/16-20	19	ALS-0421
R1/4-19	1/2-20	19	ALS-0422
R1/4-19	5/8-18	19	ALS-0423
R1/4-19	3/4-20	22	ALS-0424
R3/8-19	7/16-20	22	ALS-0425
R3/8-19	9/16-18	22	ALS-0426
R3/8-19	1/2-20	22	ALS-0427
R3/8-19	5/8-18	22	ALS-0428
R3/8-19	3/4-16	22	ALS-0429
R1/2-14	1/2-20	27	ALS-0430
R1/2-14	9/16-18	27	ALS-0431
R1/2-14	5/8-18	27	ALS-0432
R1/2-14	3/4-16	27	ALS-0433
R1/2-14	7/8-14	27	ALS-0434
R1/2-14	1-1/16-12	27	ALS-0435
R3/4-14	3/4-16	32	ALS-0436
R3/4-14	7/8-14	32	ALS-0437
R3/4-14	1-1/16-12	32	ALS-0438
R3/4-14	1-5/16-12	36	ALS-0439
R1-11	1-1/16-12	41	ALS-0440
R1-11	1-5/16-12	41	ALS-0441

REDÜKSİYON

REDUCER

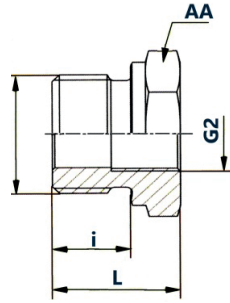

Kısa Tip / Short Type

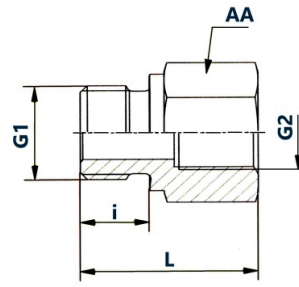

Uzun Tip / Long Type

®

TİP TYPE	G1	G2	L	AA	ITEM CODE PARÇA KODU
KISA TİP SHORT TYPE	R3/8-19	R1/8-28	22	22	ALS-0442
	R1/2-14	R1/4-19	24	27	ALS-0443
	R3/4-14	R1/4-19	26	32	ALS-0444
	R3/4-14	R3/8-19	26	32	ALS-0445
	R1-11	R1/4-19	29	41	ALS-0446
	R1-11	R3/8-19	29	41	ALS-0447
	R1-11	R1/2-14	29	41	ALS-0448
	R1-1/4-11	R1/2-14	32	50	ALS-0449
	R1-1/4-11	R3/4-14	32	50	ALS-0450
	R1-1/2-11	R1/2-14	36	55	ALS-0451
	R1-1/2-11	R3/4-14	36	55	ALS-0452
	R1-1/2-11	R1-11	36	55	ALS-0453
UZUN TİP LONG TYPE	R1/4-19	R1/8-28	28	19	ALS-0454
	R3/8-19	R1/4-19	36	22	ALS-0455
	R1/2-14	R3/8-19	36	27	ALS-0456
	R3/4-14	R1/2-14	41	32	ALS-0457
	R1-11	R3/4-14	47	41	ALS-0458
	R1-1/4-11	R1-11	52	50	ALS-0459

LÜLE

ADAPTER

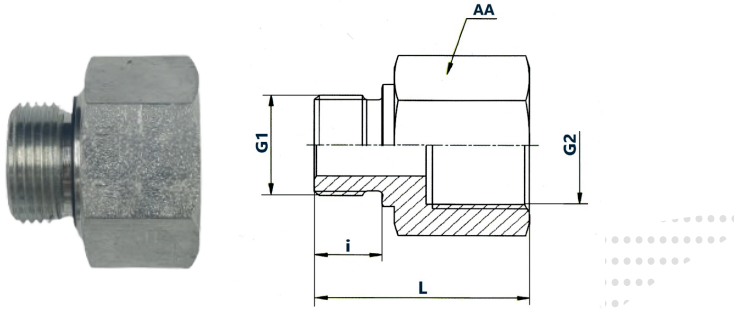

G1	G2	AA	ITEM CODE PARÇA KODU
R1/8-28	R1/4-19	19	ALS-0461
R1/8-28	R3/8-19	22	ALS-0462
R1/4-19	R3/8-19	22	ALS-0463
R1/4-19	R1/2-14	27	ALS-0464
R1/4-19	R3/4-14	32	ALS-0465
R3/8-19	R1/2-14	27	ALS-0466
R3/8-19	R3/4-14	32	ALS-0467
R1/2-14	R3/4-14	32	ALS-0468
R1/2-14	R1	41	ALS-0469
R3/4-14	R1-11	41	ALS-0470
R3/4-14	R1-1/4-11	50	ALS-0471
R3/4-14	R1-1/2-11	55	ALS-0472
R1-11	R1-1/4-11	50	ALS-0473
R1-11	R1-1/2-11	55	ALS-0474
R1-1/4-11	R1-1/2-11	55	ALS-0475
R1-1/4-11	R2	70	ALS-0476
R1-1/2-11	R2	70	ALS-0477

BSP ANAHTAR BAŞLI KÖR TAPA

BSP PLUG

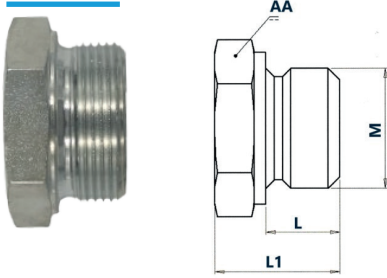

G	AA	ITEM CODE PARÇA KODU
R1/8-28	14	ALS-0478
R1/4-19	19	ALS-0479
R3/8-19	22	ALS-0480
R1/2-14	27	ALS-0481
R3/4-14	32	ALS-0482
R1-11	41	ALS-0483
R1-1/4-11	50	ALS-0484
R1-1/2-11	55	ALS-0485
R2-11	70	ALS-0486

BSP ALYAN BAŞLI KÖR TAPA

BSP INTERNAL HEX PORT PLUG

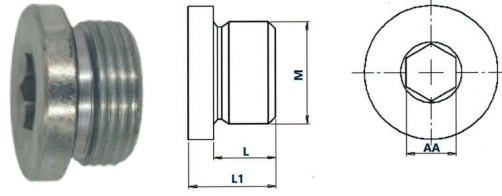

G	AA	ITEM CODE PARÇA KODU
R1/8-28	5	ALS-0487
R1/4-19	6	ALS-0488
R3/8-19	8	ALS-0489
R1/2-14	10	ALS-0490
R3/4-14	12	ALS-0491
R1-11	14	ALS-0492
R1-1/4-11	17	ALS-0493
R1-1/2-11	22	ALS-0494
R2-11	22	ALS-0495

METRİK ANAHTAR BAŞLI KÖR TAPA

METRIC PLUG

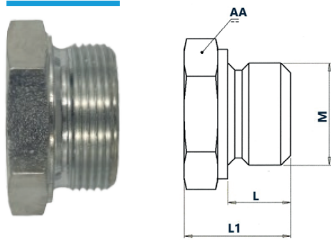

M	AA	ITEM CODE PARÇA KODU
M12X1.5	17	ALS-0496
M14X1.5	19	ALS-0497
M16X1.5	22	ALS-0498
M18X1.5	24	ALS-0499
M20X1.5	27	ALS-0500
M22X1.5	27	ALS-0501
M24X1.5	30	ALS-0502
M26X1.5	32	ALS-0503
M30X2	36	ALS-0504
M36X2	46	ALS-0505

METRİK ALYAN BAŞLI KÖR TAPA

METRIC INTERNAL HEX PORT PLUG

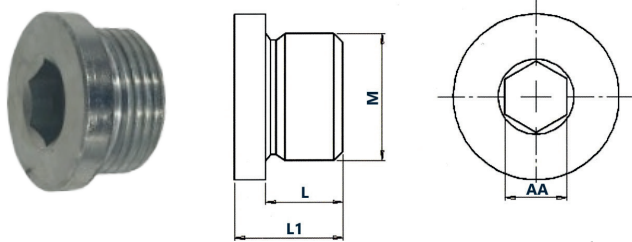

M	AA	ITEM CODE PARÇA KODU
M12X1.5	6	ALS-0506
M14X1.5	6	ALS-0507
M16X1.5	8	ALS-0508
M18X1.5	8	ALS-0509
M20X1.5	10	ALS-0510
M22X1.5	10	ALS-0511
M24X1.5	12	ALS-0512
M26X1.5	12	ALS-0513
M30X2	14	ALS-0514
M36X2	17	ALS-0515

METRİK ERKEK KÖR TAPA

METRIC PLUG

M	AA	ITEM CODE PARÇA KODU
M12X1.5-6L	12	ALS-0516
M14X1.5-8L	14	ALS-0517
M16X1.5-10L	17	ALS-0518
M18X1.5-12L	19	ALS-0519
M20X1.5-12S	22	ALS-0520
M22X1.5-15L	27	ALS-0521
M24X1.5-16S	30	ALS-0522
M26X1.5-18L	32	ALS-0523
M30X2-22L	36	ALS-0524
M30X2-20S	36	ALS-0525
M36X2-25S	46	ALS-0526
M42X2-30	50	ALS-0527
M52X2-42L	60	ALS-0528
M52X2-38S	60	ALS-0529

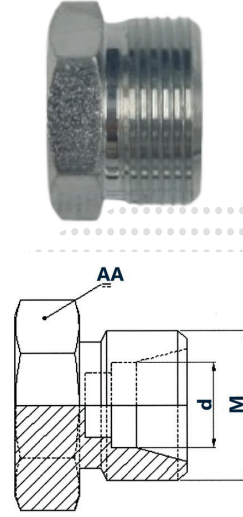

METRİK SOMUNLU KÖR TAPA

METRIC SEALING CAP

M	AA	ITEM CODE PARÇA KODU
M12X1.5-6L	12	ALS-0530
M14X1.5-8L	14	ALS-0531
M16X1.5-10L	17	ALS-0532
M18X1.5-12L	22	ALS-0533
M20X1.5-12S	24	ALS-0534
M22X1.5-15L	27	ALS-0535
M24X1.5-16S	30	ALS-0536
M26X1.5-18L	32	ALS-0537
M30X2-22L	36	ALS-0538
M30X2-20S	36	ALS-0539
M36X2-25S	46	ALS-0540
M42X2-30	50	ALS-0541
M52X2-42L	60	ALS-0542
M52X2-38S	60	ALS-0543

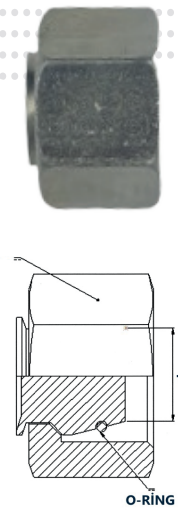

ÇEKİRDEK KÖR TAPA

CORE PLUG

D	L	ITEM CODE PARÇA KODU
8	18	ALS-0544
10	20	ALS-0545
12	21	ALS-0546
15	21	ALS-0547
16	23	ALS-0548
18	22	ALS-0549
20	29	ALS-0550
22	25	ALS-0551
25	29	ALS-0552
28	26	ALS-0553
30	30	ALS-0554
38	33	ALS-0555
42	30	ALS-0556

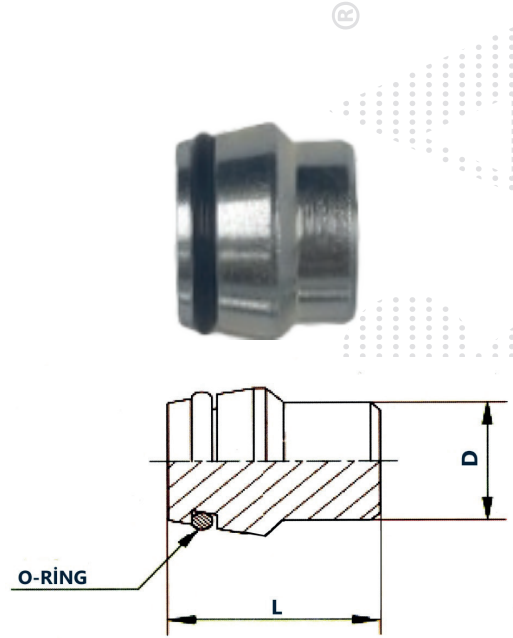

KAYNAKLIK YÜKSÜK

WELD ON NIPPLE

D	L	ITEM CODE PARÇA KODU
8	18	ALS-0557
10	20	ALS-0558
12	21	ALS-0559
15	21	ALS-0560
16	23	ALS-0561
18	22	ALS-0562
20	29	ALS-0563
22	25	ALS-0564
25	29	ALS-0565
28	26	ALS-0566
30	30	ALS-0567
38	33	ALS-0568
42	30	ALS-0569

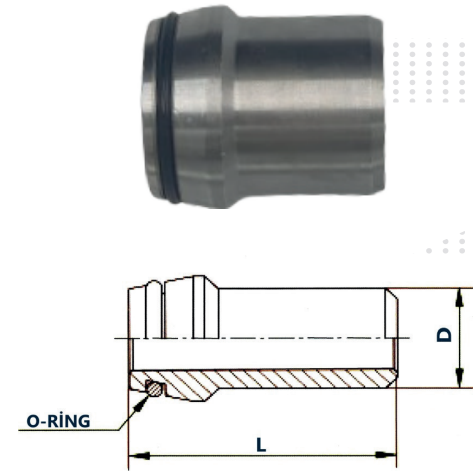

PERDE GEÇİŞ NİPELİ

BULKHEAD STRAIGHT CONNECTOR

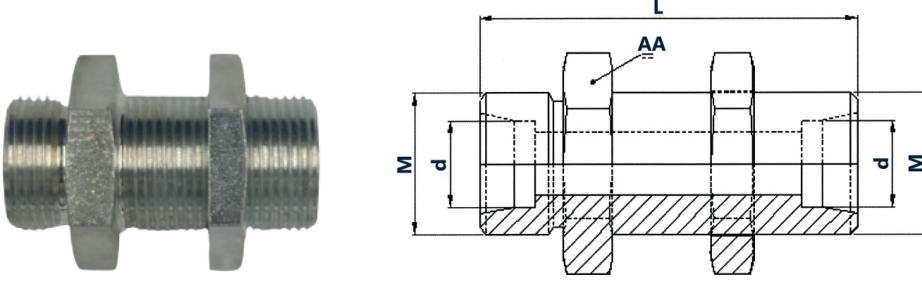

PN(BAR) BASINÇ	TUBE Ø BORU ÇAPI(d)	M	ITEM CODE PARÇA KODU	PN(BAR) BASINÇ	TUBE Ø BORU ÇAPI(d)	M	ITEM CODE PARÇA KODU
L NORMAL BASINÇ L NORMAL PRESSURE	6L	M12X1.5	ALS-0632	S YÜKSEK BASINÇ S HIGH PRESSURE	6S	M14X1.5	ALS-0642
	8L	M14X1.5	ALS-0633		8S	M16X1.5	ALS-0643
	10L	M16X1.5	ALS-0634		10S	M18X1.5	ALS-0644
	12L	M18X1.5	ALS-0635		12S	M20X1.5	ALS-0645
	15L	M22X1.5	ALS-0636		16S	M24X1.5	ALS-0646
	18L	M26X1.5	ALS-0637		20S	M30X2	ALS-0647
	22L	M30X2	ALS-0638		25S	M36X2	ALS-0648
	28L	M36X2	ALS-0639		30S	M42X2	ALS-0649
	35L	M45X2	ALS-0640		38S	M52X2	ALS-0650
42L	M52X2	ALS-0641					

KAYNAKLIK PERDE GEÇİŞ NİPELİ

WELD-IN BULKHEAD STRAIGHT CONNECTOR

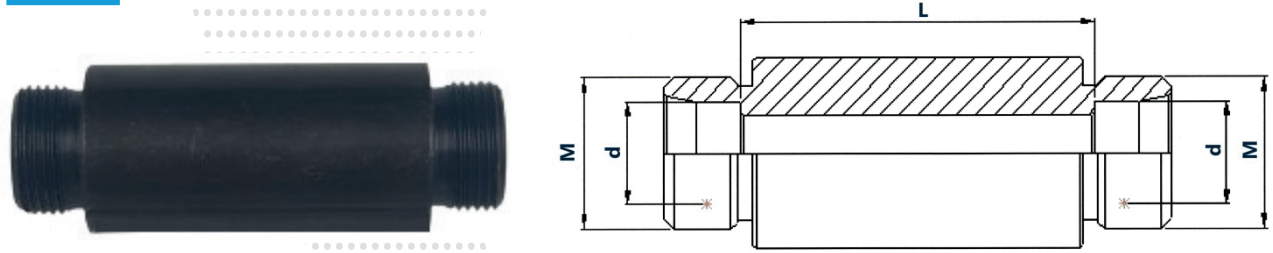

PN(BAR) BASINÇ	TUBE Ø BORU ÇAPI(d)	M	ITEM CODE PARÇA KODU	PN(BAR) BASINÇ	TUBE Ø BORU ÇAPI(d)	M	ITEM CODE PARÇA KODU
L NORMAL BASINÇ L NORMAL PRESSURE	6L	M12X1.5	ALS-0651	S YÜKSEK BASINÇ S HIGH PRESSURE	6S	M14X1.5	ALS-0661
	8L	M14X1.5	ALS-0652		8S	M16X1.5	ALS-0662
	10L	M16X1.5	ALS-0653		10S	M18X1.5	ALS-0663
	12L	M18X1.5	ALS-0654		12S	M20X1.5	ALS-0664
	15L	M22X1.5	ALS-0655		16S	M24X1.5	ALS-0665
	18L	M26X1.5	ALS-0656		20S	M30X2	ALS-0666
	22L	M30X2	ALS-0657		25S	M36X2	ALS-0667
	28L	M36X2	ALS-0658		30S	M42X2	ALS-0668
	35L	M45X2	ALS-0659		38S	M52X2	ALS-0669
42L	M52X2	ALS-0660					

MANOMETRE REKORU

PRESSURE GAUGE CONNECTOR

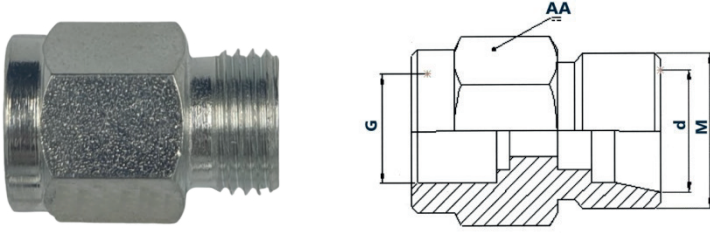

©

PN(BAR) BASINÇ	TUBE Ø BORU ÇAPI(d)	G	M	ITEM CODE PARÇA KODU
L NORMAL BASINÇ L NORMAL PRESSURE	6L	R1/4-19	M12X1.5	ALS-0670
	8L	R1/4-19	M14X1.5	ALS-0671
	10L	R1/4-19	M16X1.5	ALS-0672
	12L	R1/4-19	M18X1.5	ALS-0673
	6L	R1/2-14	M12X1.5	ALS-0674
	8L	R1/2-14	M14X1.5	ALS-0675
	10L	R1/2-14	M16X1.5	ALS-0676
	12L	R1/2-14	M18X1.5	ALS-0677

PN(BAR) BASINÇ	TUBE Ø BORU ÇAPI(d)	G	M	ITEM CODE PARÇA KODU
S YÜKSEK BASINÇ S HIGH PRESSURE	6S	R1/4-19	M14X1.5	ALS-0678
	8S	R1/4-19	M16X1.5	ALS-0679
	10S	R1/4-19	M18X1.5	ALS-0680
	12S	R1/4-19	M20X1.5	ALS-0681
	6S	R1/2-14	M14X1.5	ALS-0682
	8S	R1/2-14	M16X1.5	ALS-0683
	10S	R1/2-14	M18X1.5	ALS-0684
	12S	R1/2-14	M20X1.5	ALS-0685

SOMUN

NUTS



Ø	ITEM CODE PARÇA KODU
8	ALS-0697
10	ALS-0698
12	ALS-0699
14	ALS-0700

MARPUÇ

HOSE FITTING



Ø	ITEM CODE PARÇA KODU
8	ALS-0686
10	ALS-0687
12	ALS-0688
14	ALS-0689

PLASTİK SOMUN

PLASTIC NUTS



Ø	ITEM CODE PARÇA KODU
8	ALS-0701
10	ALS-0702



Ø	ITEM CODE PARÇA KODU
8	ALS-0690
10	ALS-0691
12	ALS-0692
14	ALS-0693

KAPSÜL

HOSE SLEEVES

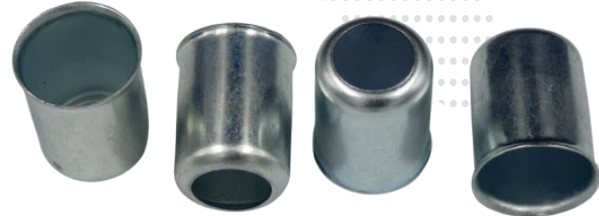

Ø	ITEM CODE PARÇA KODU
16	ALS-0703
19	ALS-0704
21	ALS-0705



Ø	ITEM CODE PARÇA KODU
10	ALS-0694
12	ALS-0695
14	ALS-0696

POMPA YEDEK PARÇALARI

PUMP SPARE PARTS



Sibop Çeşitleri
Suction Delivery Valves



Pompa Boşaltma Tapası
Pump Drain Plug



Nipel Çeşitleri
Nipple Types



Pompa Piston Tapaları
Pump Piston Plugs

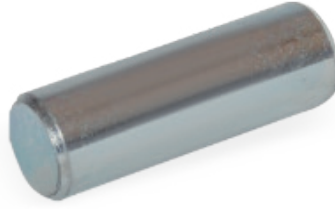

Perno Çeşitleri
Pin Types



Setskur Civata
Set Screw



Pompa Krank Mili
Pump Crankshaft

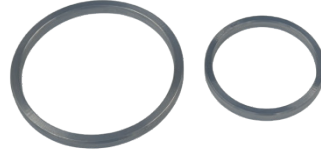

Bilezik Çeşitleri
Flange Types



Lüle Çeşitleri
Adapter Types



(G ½"E – G ½"D)
(G ½"E – G ½"E)
(G 1/2"E – G 3/8"E)
(G ½"E – G ¼"E)

Vana
Ball Valve with Lever

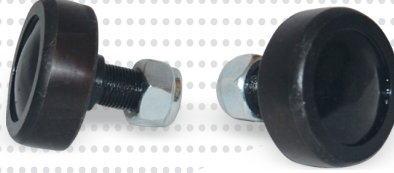

Manometre
Manometer

ÇEŞİTLİ DİĞER YEDEK PARÇALAR*VARIOUS OTHER SPARE PARTS***Seviye Gösterge Mili**
Level Indicator Shaft**Yan Kol Mili**
Side Arm Shaft**Boru Çeşitleri**
Types of Tubes**Ayar Vidaları**
Adjusting Screws**Özel Rulman Çeşitleri**
Special Bearing Types**Burç Çeşitleri**
Types of Bushing**Makara Burçları**
Roller Bushings**Yay Gerdirme Vidası**
Spring Tension Screw**Çift Kanallı Yay Pimleri**
Double Channel Spring Pins**Tek Kanallı Yay Pimleri**
Single Channel Spring Pins**Krom Bağlantı Saplama Çeşitleri**
Connection Studs

İLAÇLAMA YEDEK PARÇALARI VE REGÜLATÖRLER

SPRAYER SPARE PARTS AND CONTROL UNITS WITH VALVES



Kelepçe Meme
Nozzle Holder



Kelepçe Meme
Nozzle Holder

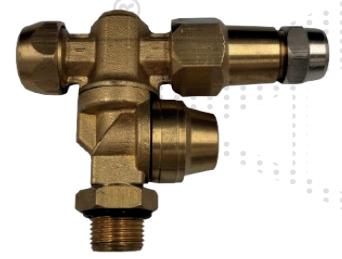

Ayarlanabilir Meme
Adjustible Nozzle

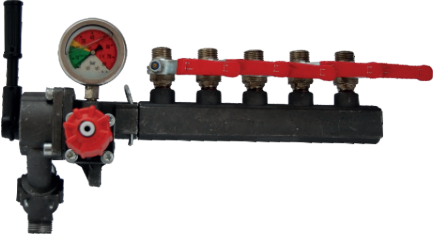

VDR 50 Regülatör 5'li Çıkış
VDR 50 Regulator 5 Output



VDR 50 Regülatör 3'lü Çıkış
VDR 50 Regulator 3 Output



Hortum Çeşitleri
Different Types of Hoses



Redüksiyon Çeşitleri
Reduction Types



Regülatör Ayar Vidaları
Regulator Adjusting Screws



Karıştırıcı Rekor-Somun
Mixer Screw and Nut



Özel Rekor Çeşitleri
Special Fittings

İLETİŞİM

CONTACT

CEO: ALAATTİN ALTAN

FİNANS: İSMAİL ALTAN

LİSANS: ULUSLARARASI TİCARET-TİCARET VE LOJİSTİK YÖNETİMİ

GSM: 0332 248 15 10 - **e-mail:** info@alisra.com.tr

FINANCE: İSMAİL ALTAN

B.SC.: INTERNATIONAL TRADE-TRADE AND LOGISTICS MANAGEMENT

PHONE: +90 332 248 15 10 - **e-mail:** info@alisra.com.tr

İNSAN KAYNAKLARI: RABİA ALTAN TEKİN (PSİKOLOJİK DANIŞMAN)

LİSANS: PSİKOLOJİK DANIŞMANLIK VE REHBERLİK

YÜKSEK LİSANS: İNSAN KAYNAKLARI VE SOSYAL GÜVENLİK

GSM: 0332 248 15 10 - **e-mail:** ik.alisraotomotiv@gmail.com

HUMAN RESOURCES: RABİA ALTAN TEKİN

(PSYCHOLOGICAL COUNSELOR)

B.SC.: PSYCHOLOGICAL COUNSELING AND GUIDANCE

M.SC.: HUMAN RESOURCES AND SOCIAL SECURITY

PHONE: +90 332 248 15 10 - **e-mail:** ik.alisraotomotiv@gmail.com

MUHASEBE: ŞEVKET YILDIRIM (MALİ MÜŞAVİR)

YÜKSEK LİSANS: MUHASEBE VE VERGİ DENETİMLERİ

GSM: 0332 248 15 10 - **e-mail:** info@alisra.com.tr

ACCOUNTING: ŞEVKET YILDIRIM (FINANCIAL ADVISOR)

M.SC.: ACCOUNTING AND TAX AUDITS

PHONE: +90 332 248 15 10 - **e-mail:** info@alisra.com.tr

ÜRETİM MÜDÜRÜ: METİN YILMAZER (USTA ÖĞRETİCİ)

GSM: 0332 248 15 10 - **e-mail:** info@alisra.com.tr

PRODUCTION MANAGER: METİN YILMAZER (TECHNICAL MANAGER)

PHONE: +90 332 248 15 10 - **e-mail:** info@alisra.com.tr

DIŞ TİCARET: RAMAZAN ÇAĞLAR

LİSANS: EKONOMİ

GSM: 0531 727 25 16 - **e-mail:** export@alisra.com.tr

INTERNATIONAL SALES MANAGER: RAMAZAN ÇAĞLAR

B.SC.: ECONOMY

PHONE: 0531 727 25 16 - **e-mail:** export@alisra.com.tr

REFERANSLAR

REFERENCES

AGROGÜL®
TARIM MAKİNALARI



ARMAŞ



GENEL ÇELİK
Sanayi ve Ticaret Limited Şirketi

KARDEŞLER
HİDROLİK BAĞLANTI ELEMANLARI(HYDROULIC FITINGS)

LIMASTAR®
AGRICULTURAL SPRAYERS

SAKA
Tarım Makinaları

TAGRİN

UNTAR®

ALAN
OTOMOTİV



ELMACILAR

EŞMESAN®



KAYHAN ERTUĞRUL
MAKİNA

LORD PLAST



TEKÖNCÜ

